

**19<sup>th</sup> EAA Annual Meeting**

European Association of Archaeologists

4-8 September 2013 | Pilsen, Czech Republic

# **EXHIBITOR UPDATE**

**19th Annual Meeting of the European  
Association of Archaeologists 2013**

**4 – 8 September 2013 | Pilsen, Czech Republic**

**[www.eaa2013.cz](http://www.eaa2013.cz)**

# GENERAL INFORMATION

## ORGANIZERS

University of West Bohemia  
GUARANT International (PCO)

### EAA 2013 Meeting Secretariat:

Ms. Simona Malinská  
Exhibition Co-ordinator  
malinska@guarant.cz

### GUARANT International spol. s r.o.

Na Pankráci 17  
140 21 Prague 4  
Czech Republic

Tel.: +420 284 001 444  
Fax: +420 284 001 448  
Website: [www.guarant.cz](http://www.guarant.cz)

## VENUE

The conference venue are two buildings located at the main campus of the University of West Bohemia. The University Campus is located not far to the main accommodation facility Parkhotel and is easily accessible by the public transport from the city centre. The Campus is conveniently located about 80 km from the German border near to the 80 exit of the D5 motorway. The parking opportunity amounting to 270 places is available free of charge at the main Campus Car park area. Pilsen is easy to reach from the **Václav Havel Airport, Prague**, which operates a wide range of international flights including low cost airlines. There will be a shuttle bus service organized between Prague and Pilsen (ca. 50 minutes).

### How to get to the university campus

#### By car

The University Campus is located on the south-western outskirts of the city and is therefore easily accessible from the motorway D5 (Prague – Germany). Use Exit 80, then continue along the road for about 5 km up. Use the first Exit "Borská pole" and turn right. This road leads to the campus, pass the petrol/gas station Benzina and turn right after passing a bus stop into the campus parking.

#### By public transport

If you arrive in Pilsen by train, take the tram No. 1 or 2 and go to Solní street (1<sup>st</sup> station after you pass Náměstí Republiky (Republic Square). Then change for the tram No. 4 (direction Bory) and go to the terminus. Here transfer onto a bus No. 24, 30 or 36 and go one stop to the campus. Alternatively you may walk from the terminus station of tram No. 4 to the university Campus, the walk takes about 7 minutes. The overall journey from the Central Train Station (Plzeň Hlavní nádraží) to the campus takes about half an hour, from the City centre about 15–20 minutes.

If you arrive in Pilsen by bus (station CAN), take the bus No. 11 or 12 from stop CAN, Tylova to stop U Práce, Americká and here just cross the street to the station (U Práce, Klatovská) take the tram No. 4 (direction Bory) and go to the terminus. Here transfer onto a bus No. 24, 30 or 36 and go 1 stop to the campus (stop Západočeská univerzita). Alternatively you may walk from the terminus station of tram No. 4 to the university Campus, the walk takes about 7 minutes. The overall journey from the Central Bus Station (CAN) to the campus takes about 22 minutes.

Please be informed that for your convenience shuttle buses from the city centre and from Parkhotel to the EAA Annual Meeting venue and back are provided in peak hours. The buses are branded with EAA Annual Meeting logo. Please do not forget to wear your name badge.

#### Time schedule on 5, 6 and 7 September 2013:

in the morning between **7:45** and **8:45**

**Route No. 1 - Museum of West Bohemia (Kopeckého sady 2) - University Campus (Univerzitní 26)**

**Route No. 2 - Parkhotel (U Borského parku 31) - University Campus (Univerzitní 26)**

in the afternoon between **17:00** and **18:00**

**Route No. 1 - University Campus (Univerzitní 26) - Museum of West Bohemia (Kopeckého sady 2)**

**Route No. 2 - University Campus (Univerzitní 26) - Parkhotel (U Borského parku 31)**

## **EXHIBITION AREA**

The exhibition area is located in the building of Faculty of Electrical Engineering (Building 1) in central foyer on the ground floor. The access to meeting rooms is from this foyer only. The registration desk and internet area will be situated in this area as well as stairs to the poster area. Also coffee breaks will be served here.

Address:

University of West Bohemia  
Faculty of Electrical Engineering  
Univerzitní 26  
306 14 Pilsen  
Czech Republic

## **EXHIBITION STAND**

Exhibition stand includes following items:

- ✓ exhibition space according to your order
- ✓ 1 or more tables (size 80 cm x 120 cm) according to your order
- ✓ 2 or more chairs according to your order
- ✓ 1 electrical outlet
- ✓ free wireless internet at the Exhibition area

## EXHIBITION SCHEDULE

### Stand Set-up & Decoration:

4 September 2013 12:00 -14:00

### Exhibition hours:

4 September 2013 14:00 – 17:00

5 September 2013 08:30 – 18:00

6 September 2013 08:30 – 18:00

7 September 2013 09:00 – 13:00

### Dismantling:

7 September 2013 13:00 – 14:00

## STORAGE

A lockable room for overnight storage will be available for all exhibitors.

## SHIPPING OF YOUR STOCKS

You can send your stocks through our partner shipping company Beckspedition located here in Prague (contacts see below) who will deliver stocks to your stand and (if required) back to Prague and store them until collected by your carrier. **This service is charged according to stock's extention. For more info & quotation please contact Beckspedition.**

### c/o BECKSPEDITION

Pavel Beck

Prague Congress Centre

5.května 65

140 00 Prague 4

Czech Republic

Fax: +420 286 881 730

Phone: +420 602 311 950 (Pavel Beck) +420 724 328 380 (Monika Veselá),

E-mail: beck.pavel@volny.cz, monik.vesela@seznam.cz

## OR

If you prefer sending your stock directly to the venue kindly note that there is no staff able to take delivery (in other words you must be present to take delivery). For sending please use following address:

University of West Bohemia (Západočeská univerzita)

Faculty of Electrical Engineering (Fakulta elektrotechnická)

Univerzitní 26

306 14 Pilsen (Plzeň)

Czech Republic

Stock should not be delivered earlier than on September 4 at noon (when set-up starts and your staff is there ready to take it).

For return transport stock should be collected from your staff anytime during dismantling hours on September 7, 13:00-14:00. If your courier is unable to collect stock on Saturday, then you can leave it (on your own risk) at the place specified by university to be collected on Monday.

## **REGISTRATION & ACCOMMODATION**

Your exhibitor package includes one or more complimentary registrations. Names should be advised in advance to Registration Manager, Ms. Lucie Teglova ([teglova@guarant.cz](mailto:teglova@guarant.cz)). Additional registrations can be made online. There are no special exhibitor fees. If you wish to book accommodation please contact Lucie Teglova or book online.

## **LIST OF EXHIBITORS**

1. University of Pittsburgh (Dept. Of Anthropology, Center for Comperative Archaeology)
2. Archeologický ústav AV
3. Archaeological Institute of America
4. Institute of Archaeologists
5. Leuven University Press
6. Society for Post-medieval Archaeology (University of Leicester)
7. Swedish National Heritage Board
8. Oxbow Books
9. Maney Publishing
10. Human Relations Area Files (HRAF) at Yale University
11. Archaeolingua Foundation
12. Society for American Archaeology
13. Archaeopress
14. SENSYS Sensorik & Systemtechnologie GmbH
15. University of York (Department of Archaeology)
16. Beta Analytic Ltd.
17. Minelab International Limited
18. GEM Systems Inc.
19. Antiquity Publication Ltd.
20. Routledge, Taylor & Francis Group
21. John Wiley & Sons Ltd.
22. 20<sup>th</sup> EAA Meeting Istanbul
23. 21<sup>st</sup> EAA Meeting
24. EAA book stand
25. World Archaeological Congress
26. Cambridge University Press (first floor)

# EXHIBITION PLAN

## Building 1, Ground Floor

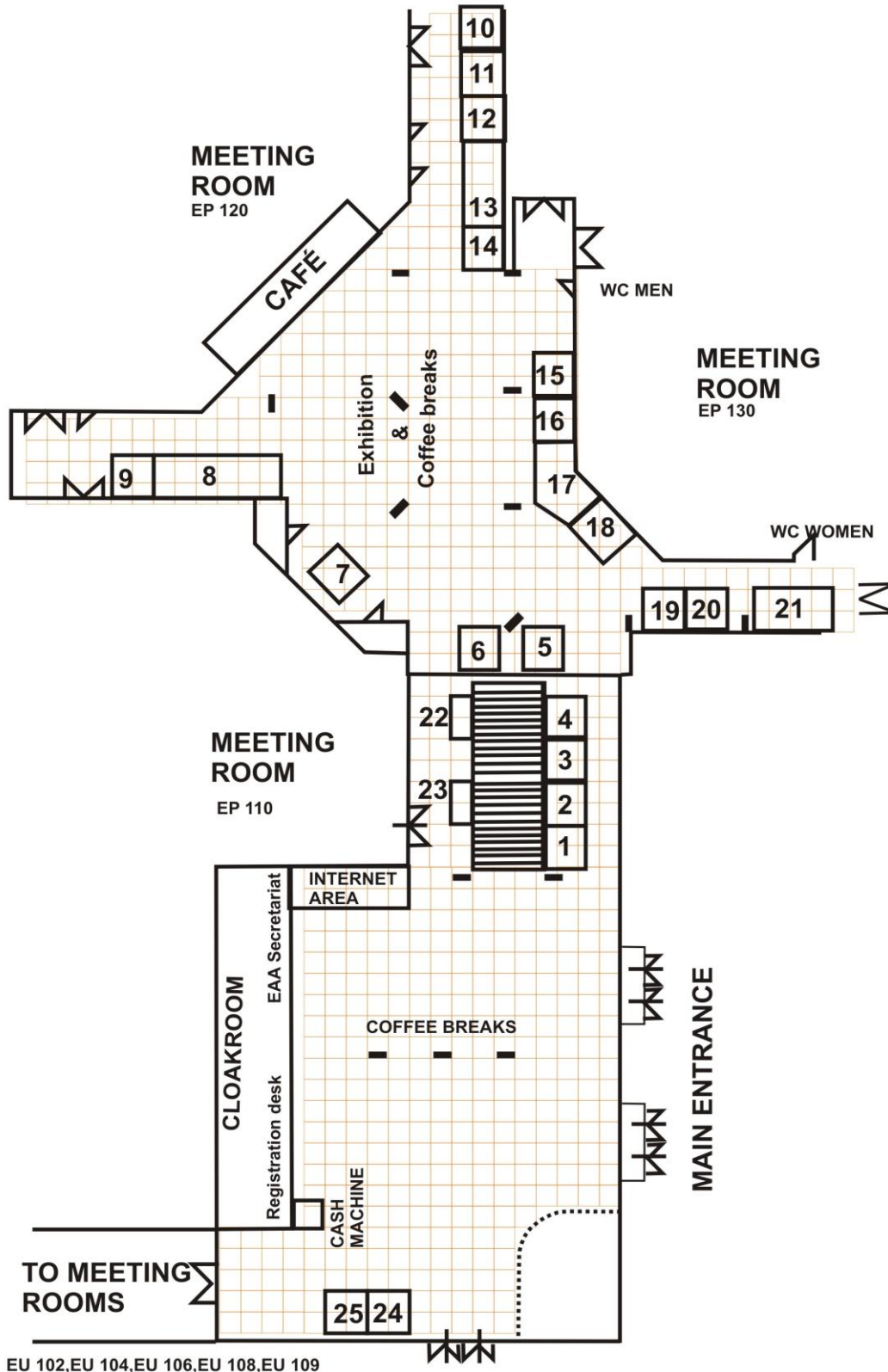

EU 102, EU 104, EU 106, EU 108, EU 109

# BUILDING 1,1<sup>st</sup> FLOOR

